

VistaFoam™
Closure strips for panel openings

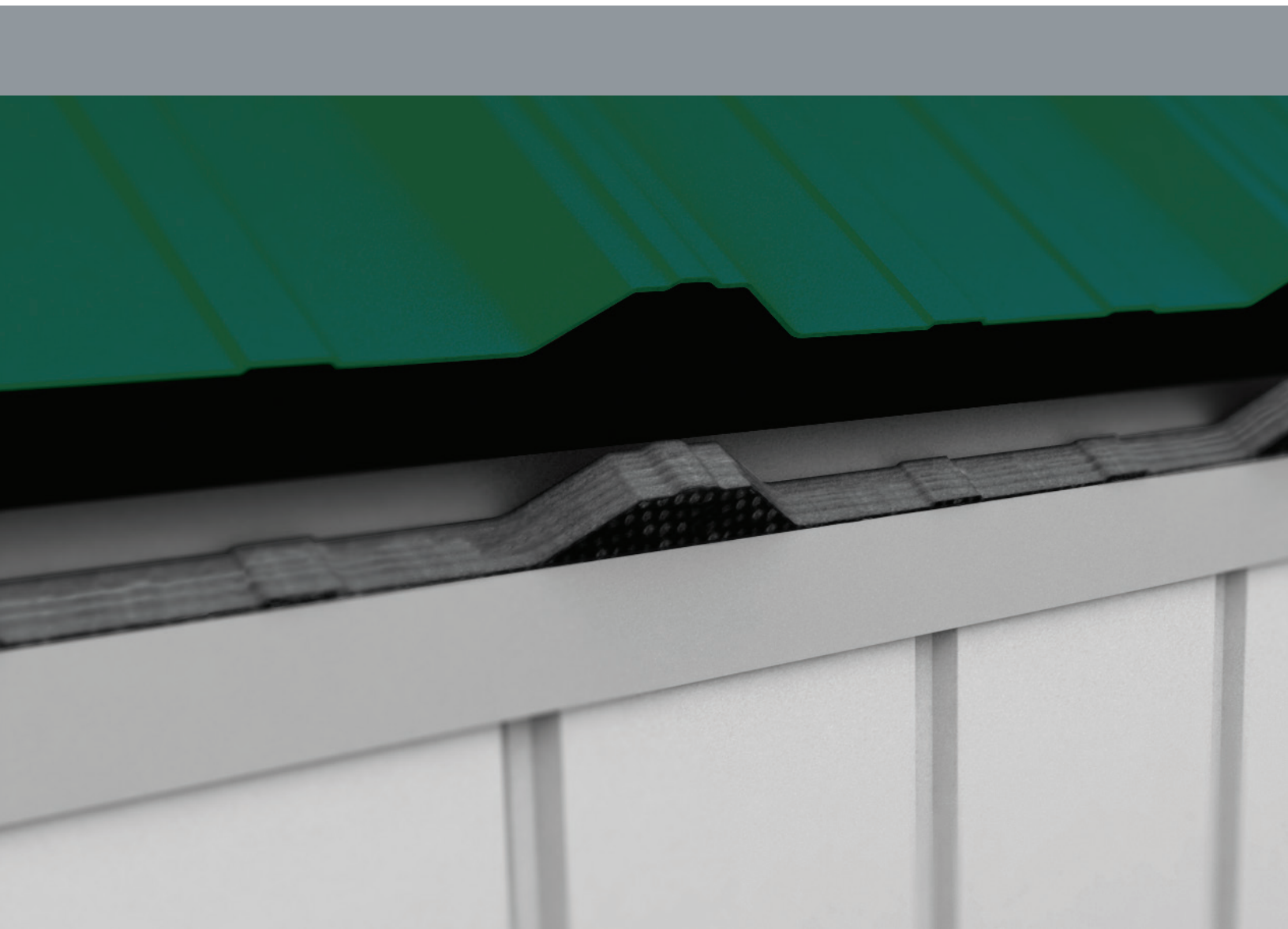

Application

VistaFoam closure is designed to close gaps in roof and sidewall applications

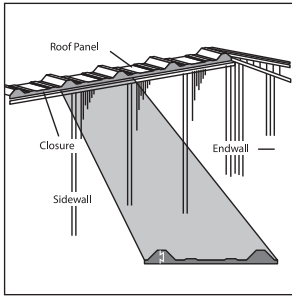

Typical Inside Closure Application

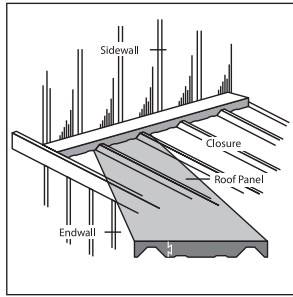

Typical Outside Closure Application



Features / Advantages

- Material thickness*: 1", 1-1/2", 2"
 - Color: Charcoal
 - Polyethylene foam for exceptional strength and compressibility.
 - Available with adhesive applied to assure positive positioning during installation.
 - Interlocking dovetail connections available on many profiles.
 - Resists damaging ultra violet rays and ozone deterioration.
 - Hundreds of profile configurations available
 - One person installation
- * Not all closure profiles available in all material thicknesses.

Technical Properties

Test	Test Method	Units	Values 1"	Values 1-1/2" & 2"
Density	BS ISO 7214 1998	lb/ft ³	1.5	1.8
Working Temperature Range	Internal	°F	212 max -94 min	212 max -94 min
Compression Deflection	BS ISO 7214 1998	psi	25%	7.7
			50%	17.1
Compression Set	BS ISO 7214 1998	% set	25% - 1/2 hr	13.0
			25% - 24 hr	5
Tear Strength	BS EN ISO 8067 1995	lb/in	2.8	4.2
Tensile Strength	ISO 7214 1998	psi	46.4	54.4
Elongation		%	130	140
Flammability	FMVSS302	4"/min	Pass	Pass
Shore Hardness	ISO 868 1985	OO	50	53

Maximum service temperature is 212° F. Applications where service temperature exceeds 212° F should be avoided, as the material can experience thermal degradation.

VistaFoam closure is not recommended for installation or placement beneath translucent or clear materials where it may be exposed to direct sunlight. The potential intensification of the sun's rays may result in increased temperatures which could effect the condition of the material.

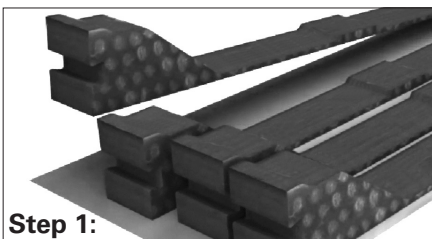

Step 1:

Ensure the self-adhesive closure configuration fits the roof panel used.

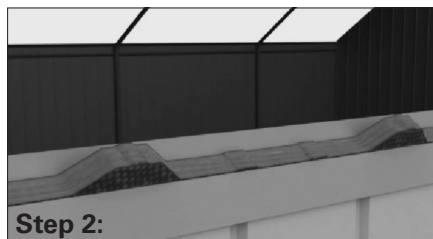

Step 2:

The inside closure fits the underside of the panel. Position the honeycomb texture side outward for optimal UV protection.



Step 3:

Place the roof panel over pre-cut closure configuration for a snug fit. Attach panel over closure with the proper fasteners.

Technical advice and sales service

SFS intec
Division Construction
1045 Spring Street
PO Box 6326
US-Wyomissing, PA 19610

800 234 4533
T +1 610 376 5751
F +1 610 376 8551
us.construction@sfsintec.biz
www.sfsintecusa.com

SFS intec - Canada
40 Innovation Drive
Dundas, ON L9H 7P3
T +1 905 689 5401
ca.info@sfsintec.biz
www.sfsintec.ca

SFS intec

Turn ideas into reality.